



Luminaria Predator LED

Installation Instructions



Thank you for purchasing Luminaria Predator LED by our company. Our goal is to provide growers with the best sustainable light farming solutions to help them save energy and carbon emissions while increasing plant yield and quality. Please familiarize yourself with the following installation warnings and guidelines for safe and correct use.

Installation guide - warning

Note:

- This product has done reasonable matching of electrical characteristics with our T5 LED lamps, which is only used for configuring T5 LED lamps by our company.
- this lamp is not compatible with lamps using remote starters.
- T5LED lamps and electronic ballast can be replaced according to product label requirements.

WARNING - Risk of fire or electric shock. LED Retrofit Kit installation requires knowledge of luminaire electrical systems. Installation should be performed only by a qualified electrician in accordance with the National Electrical Code and relevant local code.

Warning - if the lamp or fixture is not operating properly (buzzing, flashing, etc.), immediately turn off the power, remove the lamp from the fixture and contact the manufacturer.

Warning - danger of fire. Do not install in preheating lamps.

Warning - fire danger. Use only where indicated on the label. See the command.

This lamp only works on electronic ballast. When the lamp is energized, if it is not lit, remove the lamp from the lamp and contact the lamp manufacturer or qualified electrician.

This product may cause interference with radio equipment and should not be installed near maritime safety communication equipment or other critical navigation or communication equipment between 0.45 and 30MHZ.

These devices are not intended to be used with emergency exit devices or emergency exit lights. Lamps must be operated at ambient fixture temperatures 4F (-20°C) and 95 F(35°C).

Do not install the lamp directly on the ac power supply.

This lamp is not dimmable and cannot be used with dimmer.

This lamp is not intended for exposure to weather and/or water

Installation guide - internal wiring diagram

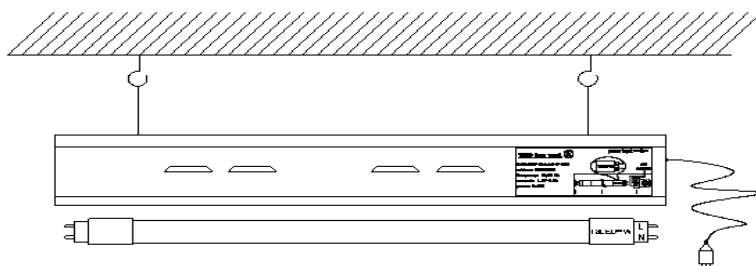
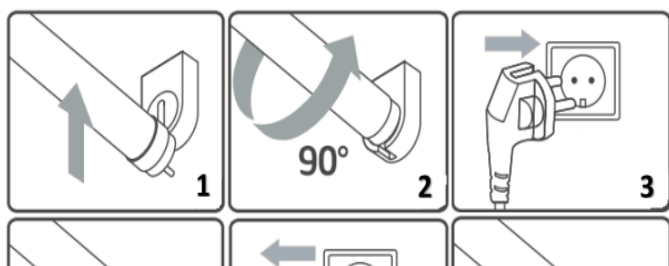

Figure 1

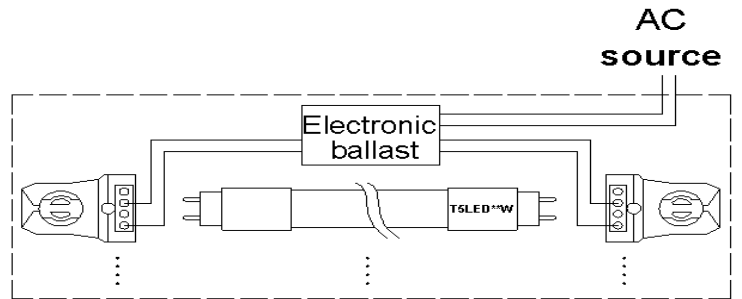

Figure 2

Figure 3